



HOT-MATE



FEATURES AND BENEFITS

- Versatility – Hot-Mate serves as a Banquet Cart/Heating Cabinet
HM84W Hot-Mate includes:
 - Plate-Mate column which holds up to 84 – 12½" plates without plate covers
 - 4 Wire racks which hold up to 48 – 2½" full size hotel pans
- HM84W31 3 in 1: Includes:
 - Choice of a standard mobile frame (PM84120) or a
 - Collapsible mobile frame (PM84-135)
- 2" Thick fully insulated holding cabinet keeps prepared foods at serving temperatures.
- Operates in a moist or dry environment.
- Stainless steel construction throughout for ease of cleaning.
- Powerful yet efficient 1500 watt heating systems with 100 Volt Operation.
- Digital control panel.
- Heavy duty 5" swivel casters, front casters equipped with brakes. Provides mobility when fully loaded.

www.plate-mate.com

The Product Group, Inc.
Canton, Ohio

1-800-860-6283
www.plate-mate.com



MODEL NO.	HOLDING CAPACITY WITH PM84 STANDARD	OUTSIDE DIMENSION			INSIDE DIMENSION			WEIGHT ACT.		
		WIDTH	DEPTH	HEIGHT	WIDTH	DEPTH	HEIGHT			
HM84W	84 PLATES 12" DIA.	37.375	31.625	76.688	27.625	27.625	66	IN	305	LBS
		94.9	80.3	194.7	70.1	70.1	167.6	CM	139	KG

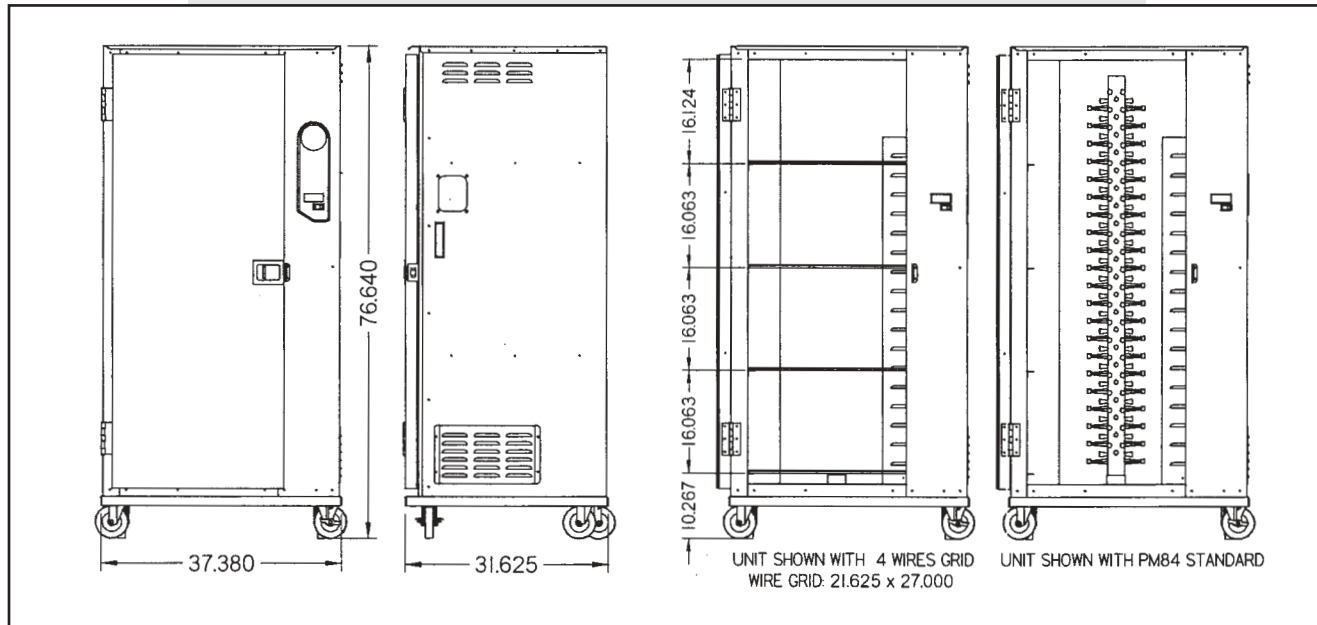

CABINET:

- Body: Stainless steel (304); exterior 22 ga., finish #3; interior 22 ga.
- Reinforcement/Internal frame: Aluminum .125.
- Insulation: Fiberglass; 2" thick, thermal conductivity (K factor) is .23 @ 75°F.
- Hold **PM84 STANDARD** Plate Mate or four nickel chrome plated wire grids, 21.625 x 27.000.

BASE:

- One piece construction, .190 aluminum.
- Casters: 5" dia., swivel, neoprene tires, 1.250 wide, load cap 200 lbs. each, temp. range -20°/+160°F. Bearings are sealed and permanently lubricated. Front casters equipped with brakes.

DOOR:

- Formed 22 ga. 304 stainless steel finish #3.
- Door gasket: Perimeter type, silicone.
- Latch: Polished stainless steel, slam type; mounted inboard.
- Hinges: heavy duty butt hinges 11 ga. stainless steel.
- Door swing 270°.

PROOF/HOT UNIT COMPONENTS:

- Powerful, yet efficient, 1500 Watt heating system.
- Advance power management for fast response.
- Switch: ON-OFF rocker type.
- Power cord: Permanent, 6 ft.
- Blower motor (1).
- Heater: (2) 500 Watt & 1000 Watt.

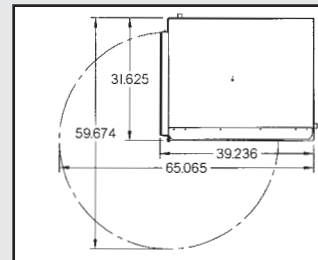

PROOF/HOT UNIT COMPONENTS (CONT.):

- Water pan: 3-1/2 quart, 18 ga. 304 stainless steel with 1000 Watt heater for humidity.
- Thermostat (holding): Solid state, room ambient to 200°F, (93°C).
- Thermostat (humidity): Solid state, room ambient to 95%.
- Digital thermometer.

POWER REQUIREMENTS:

- 1600 Watts, 120V, 60Hz, single phase, 15A.

ACCESORIES and OPTIONS:

- Perimeter Bumper
- Various Caster Option
- Adjustable wire shelf on 1-1/2" centers
- 240 Volt service

THE PRODUCT GROUP, INC. DBA PLATE-MATE

5211 West Tuscarawas Street; Canton, OH, 44708
Phone: 1-800-860-MATE/ Fax: 330-477-8599
www.plate-mate.com